

FL-710

OUTDOOR LIGHTING LUMINAIRE

Project _____
Location _____
Quote/ Ref # _____

The **FL-710** is an outdoor LED accent light with multiple beam and shroud options. It can rotate 360° and can be tilted 180° allowing for a more precise lighting scheme. Various accessories are available for different mounting options. Made of die-cast aluminum, it is extremely durable to ensure a longer lifetime. Its optimized heat dissipation allows the luminaire to be operated in extended lengths of time. Suitable for outdoor lighting such as building facades, gardens, lawns, tree accent lighting, and common outdoor areas.



SPECIFICATIONS

| | |
|---------------------|-----------------------------|
| INPUT VOLTAGE | 120V AC |
| WATTAGE | 4W/ 8W |
| DIMMING | TRIAC Dimming |
| LUMEN OUTPUT | 70Lm/ W |
| HOUSING | Die-cast Aluminum |
| FRONT COVER | Tempered Glass |
| FINISH TYPE | Powder Coating |
| DRIVER TYPE | Constant Current (Built-In) |
| AMBIENT TEMPERATURE | -20 ~ 45°C (-4 ~ 113°F) |
| IP RATING | IP65 |
| CERTIFICATIONS | ETL |

FEATURES

- 120V AC (No Transformer Needed)
- TRIAC Dimming
- Available in 4W and 8W
- Multiple optic Options
- 360° Rotate | 180° Tilt
- Die-cast Aluminum Housing
- IP65 Outdoor/ Wet Rated



| MODEL | WATTS | COLOR TEMP | OPTICS | CRI | SHROUD | FINISH | ACCESSORIES | |
|--------|--------------|-------------------|-------------------|------------|--------------------------------|--------------|--|---|
| FL-710 | 4 4W | 27K 2700K | 15 15° | 80 Ra80 | NS No Shroud | BK Black | KA Mounting Bracket A | HC Honeycomb Louver |
| | 8 8W | 30K 3000K | 25 25° | 90 Ra90 | AS Angled Glare Shield | WH White | KB Mounting Bracket B | MR Marine Ambient Corosion Resistant |
| | | 40K 4000K | 40 40° | | OS Straight Glare Shield | GR Gray | KC 4.5" Round Cover | PC Pole Clamp |
| | 50K 5000K | AH H55° x V20° | | | | BZ Bronze | JB Junction Box | |
| | | | HV H20° x V55° | | | SI Silver | SHV High Voltage Ground Stake | |
| | | | | | | | PJB Tree Strap with Junction Box | |

FL-710

OUTDOOR LIGHTING LUMINAIRE

DIMENSIONS

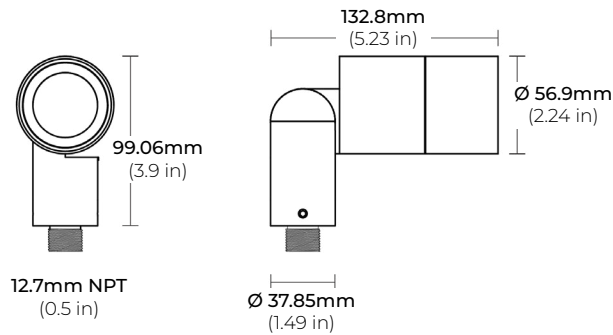

SHROUDS

AS
ANGLED GLARE SHIELD

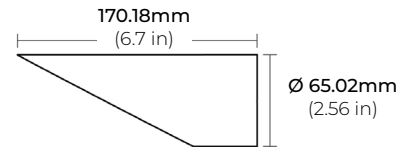

OS
STRAIGHT GLARE SHIELD

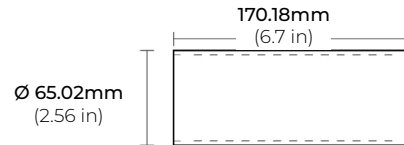

ACCESSORIES

FL700-KA
MOUNTING BRACKET A

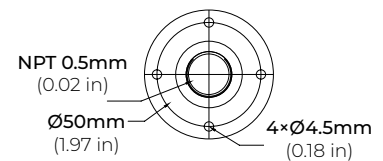
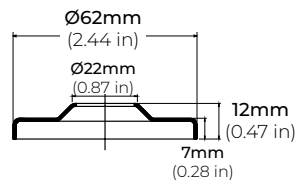

FL700-KB
MOUNTING BRACKET B

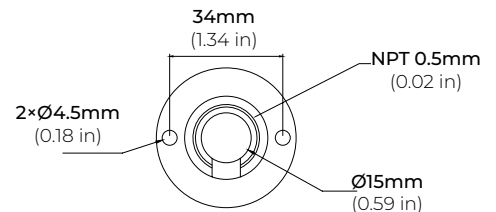
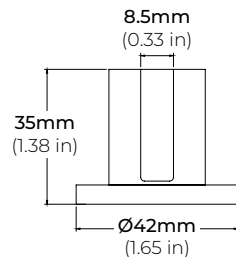

FL700-KC
4.5" ROUND COVER

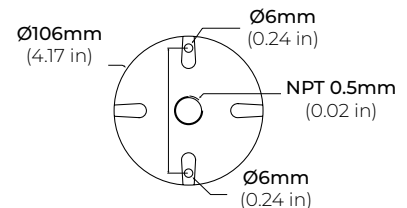

FL-710

OUTDOOR LIGHTING LUMINAIRE

ACCESSORIES

FL700-JB
JUNCTION BOX

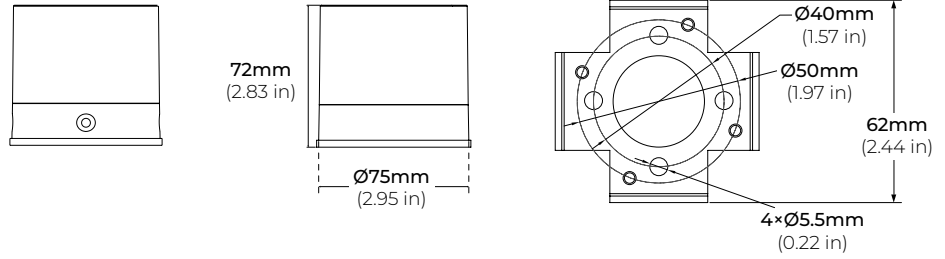

FL700-SHV
HIGH VOLTAGE GROUND STAKE

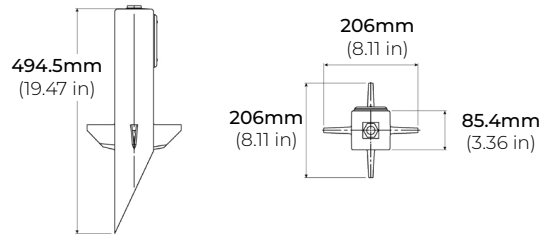

FL700-PJB
TREE STRAP WITH JUNCTION BOX

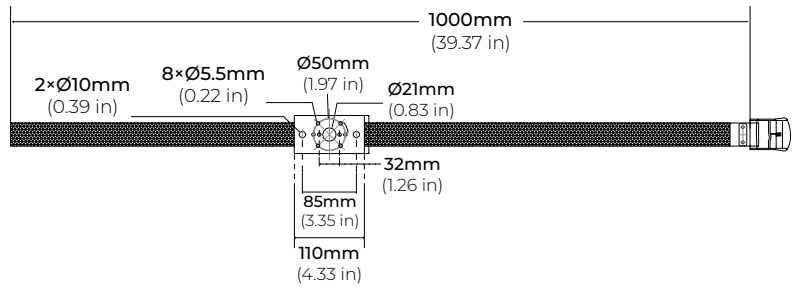

FL700-HC
HONEYCOMB LOUVER

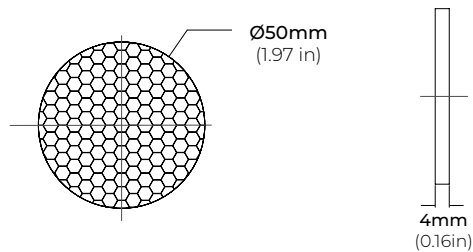

FL700-PC
POLE CLAMP

